

ZKTeco

MiniAC

SIP-Ready Multi-Biometric Access Control Terminal with Video Intercom Capability



Facial Authentication



RFID



IP65 dust & waterproof rating



Video Intercom (SIP)

Compatible with

ZKBio CVSecurity

BioTime Cloud2.0

easy TimePro

ZKBio Zlink

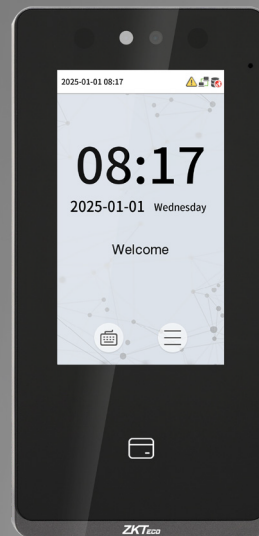

MiniAC

Introduction

MiniAC adopts the latest intelligent engineering facial authentication and technology. facial, card authentication with large capacity and speedy authentication, adopts ultimate antispoo algorithm for facial authentication against almost all types of fake photos and videos attack, which offering secure biometric authentication.

MiniAC is an access control terminal featuring a video intercom function and supports ONVIF protocol. It fully improves the video intercom experience and can be compatible with video intercom indoor unit with SIP protocol (Version 2.0).

Besides, MiniAC supports multiple communication protocols. Its firmware has AC push and can convert to TA push and it is compatible with various AC or TA software. It can change to BEST protocol to link with ZKBio Zlink (AC module).

Features

- Visible Light Facial Authentication Technology
- Attained IP65 Protection Rating With Dustproof and Waterproof
- Multiple Authentication Methods: Facial / RFID / Password
- Available RFID Modules:125 kHz ID Card / 13.56 MHz IC Card
- HD Video Door Phone Via SIP Protocol (Version 2.0)
- Rechargeable backup battery.
- User Data Synchronization: User data can be downloaded/uploaded from one device to another via a USB drive
- Compatible with wireless doorbell (optional)
- Advanced access control functions (Wiegand input or output shared; RS485 communication; Electric Lock; Door Sensor; Exit Button)

* Download data using the USB driver and make sure to use the FAT32 format.

Specifications

Model	MiniAC
Display	4.3"@ TFT Color Touch LED Screen (272*480)
Camera	WDR Binocular Camera @ 1MP
Operation System	Linux
Hardware	CPU: Dual Core@1GHz RAM: 512MB; ROM: 8GB Speaker: 8ohm @1W Microphone: *1 (Sensitivity: -42 dB/ Omni-directional/ Signal-to-Noise Ratio: 58 dB/ Impedance: 2.2kΩ) Supplement Light: No
Authentication method	Face / Card / Password (Virtual Keypad)
Face Template Capacity	1,500 (1:N) (Standard)
Card Capacity	1,500 (1:N) (Standard)
User Capacity	1,500 (1:N) (Standard)
Transaction Capacity	200,000 (1:N)
Max. User Password Length	8 Digits
Biometric Authentication Speed	less than 0.35 sec (Facial Authentication)
Touchless Biometric Authentication Distance	30cm to 200cm (Facial Authentication)
False Acceptance Rate (FAR) %	FAR ≤ 0.01% (Visible Light Facial Authentication)
False Rejection Rate (FRR) %	FRR ≤ 0.02% (Visible Light Facial Authentication)
Biometric Algorithm	ZKFace V4.0
Card Type	ID Card@125 kHz (Standard) IC Card@13.56 MHz (Optional)
Communication	TCP/IP*1, Wi-Fi (IEEE802.11b/g/n/ax) @ 2.4 GHz, Wiegand (Input or Output)*1, RS485: ZKTeco RS485*1, USB: Type A (USB Drive Only)*1, Aux Inputs *1, Electric Lock*1, Door Sensor*1, Exit Button*1, 12V Output*1
Standard Functions	Backup Battery, ADMS, DST, Photo Capture, Event Photo Capture, Up to 14-digit User ID, Access Levels, Groups, Holidays, Anti-Passback, Record Query, Schedule Bell, Tamper Switch Alarm, Automatic Status Switch, Multiple AuthenticationMethods, SIP Client (Version 2.0), ONVIF (Compatible with Profile S, Profile T, Profile G, Profile C, Profile Q & Profile A) AC Push and TA Push Protocol Switch, HTTPs / SSH Backend Access, T9 Keyboard (Input)
Optional Functions	IC Card, Wireless Doorbell
Video Intercom	Video Intercom (ZKTeco Private Protocol via TCP/IP) Support Devices: Indoor Monitor: VT07-B01, VT07-B01-W Video Intercom (Standard SIP Protocol) Support Devices: Indoor Monitor: VT07-B22L, VT07-B26L-W Software: ZKBio CVSecurity Mobile App: ZKBio Zlink, ZKBio Zexus
Access Control Interface	RS485 (RS485 Card Reader / Biometric Reader)
Power Supply	DC 12V 3A, Backup Battery (2000 mAh, Lithium Battery)
Operating Temperature	-5°C to 45°C
Operating Humidity	10% to 90% RH (Non-condensing)
Dimensions	175.00 mm * 84.50 mm * 21.65 mm (L*W*H)
Net Weight	0.264 Kg
Supported Software	On-Premise Software: ZKBio CVSecurity (AC PUSH) & easy TimePro (TA PUSH) Cloud-based Software: BioTime Cloud 2.0, ZKBio Zlink (Supports Web Portal & Mobile App)
Installation	Wall-mount (Compatible with Asia Gang Box / Single Gang Box)
Ingress Protection Rating	IP65 (waterproof and dustproof)
Certifications	ISO14001, ISO9001, CE, FCC, RoHS

Configuration

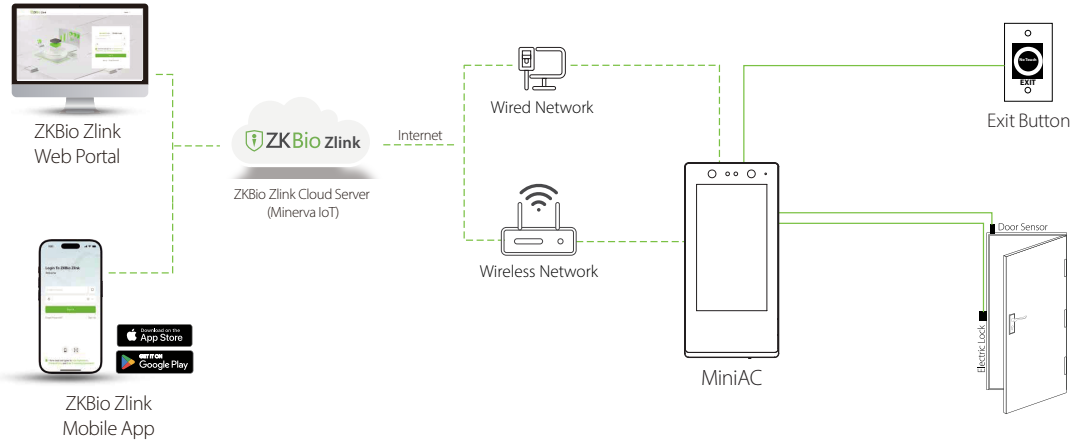

BEST Protocol

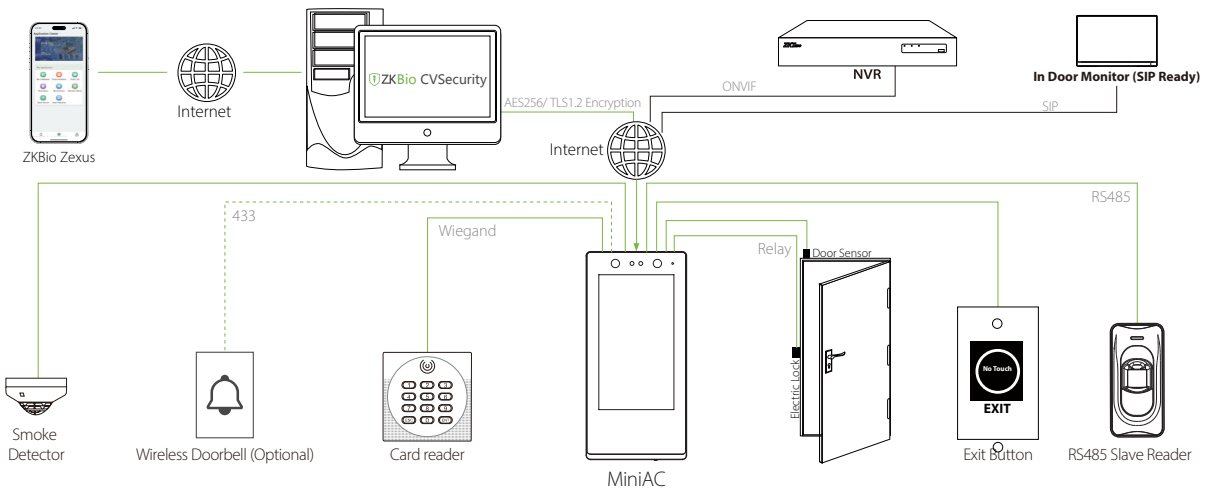

PUSH Protocol

Dimensions (mm)

